

## DISASSEMBLY

1. Remove the clutch release bearing and fork(A).

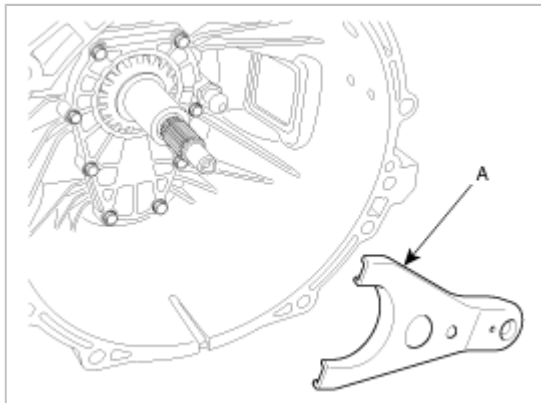

2. Remove the clutch release fork boot.
3. Remove the control lever complete(A).

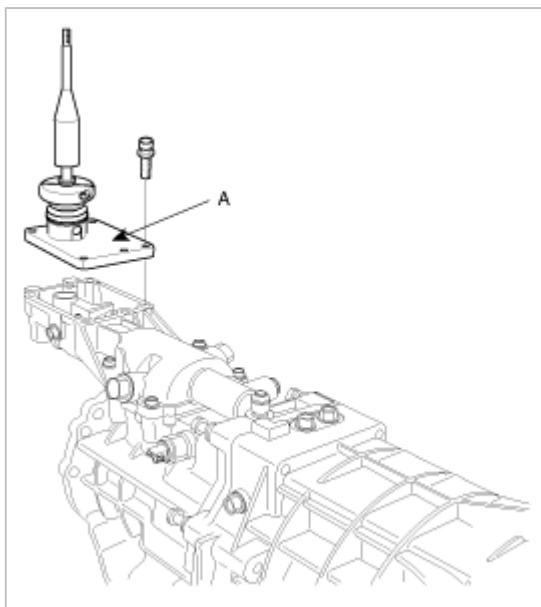

4. Remove the transmission control housing assembly(A).

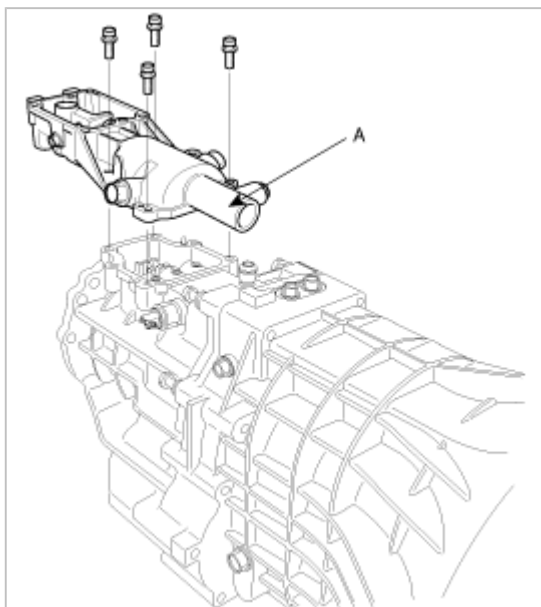

5. Remove the oil filler plug(A) and the back up lamp switch(B).

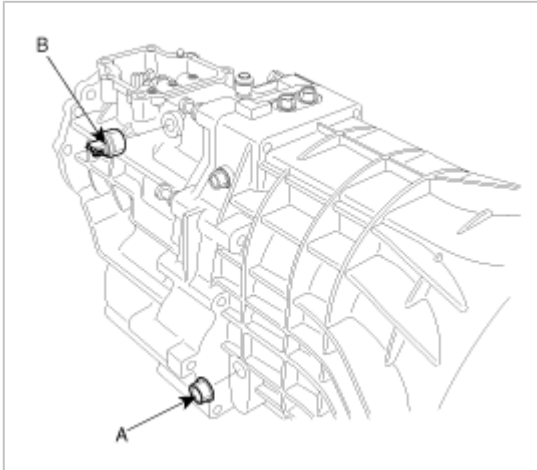

6. Using a pin extractor(A), remove the spring pin from the shift rail.

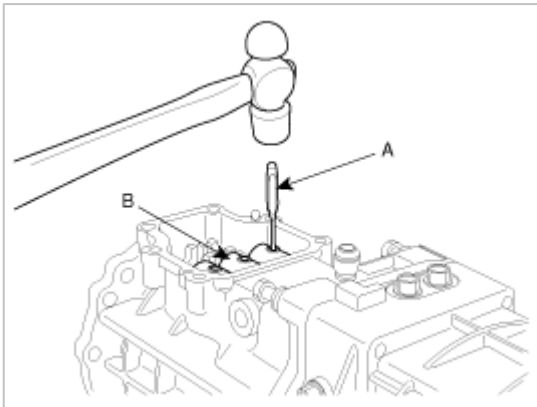

7. Remove the shift rail control jaws(B).

8. Remove the transfer adapter(A) loosening the bolts.

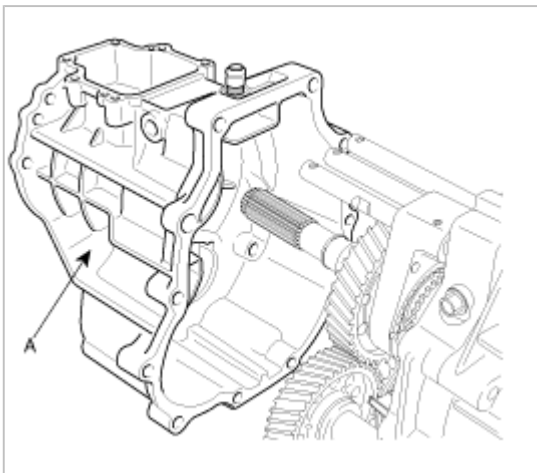

9. Remove the front bearing retainer assembly(A).

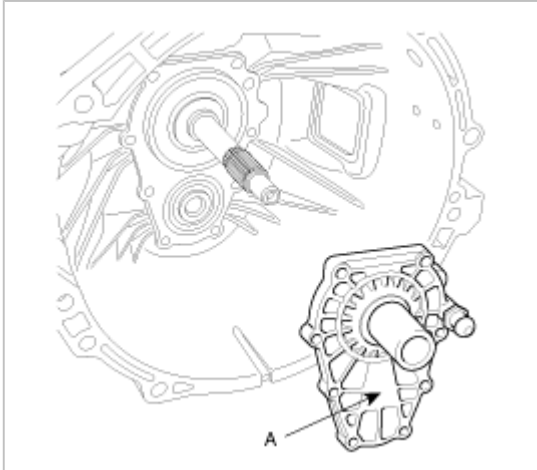

10. Remove the front bearing retainer spacer(A).

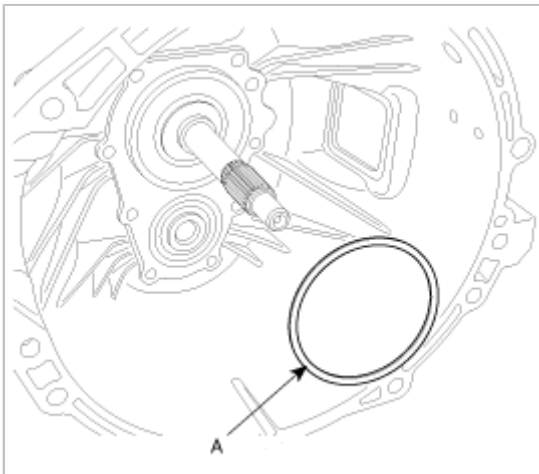

11. Remove the snap ring(A).

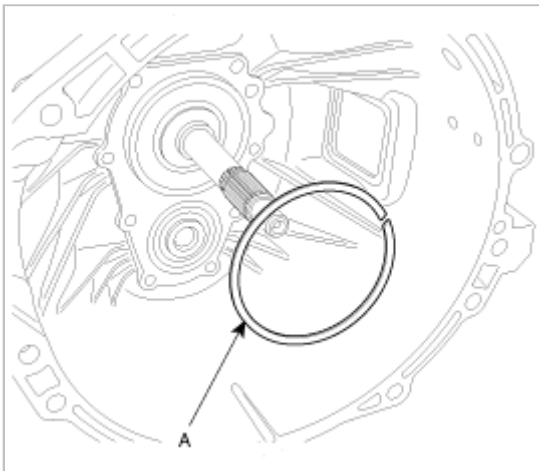

12. Remove the transmission case assembly(A).

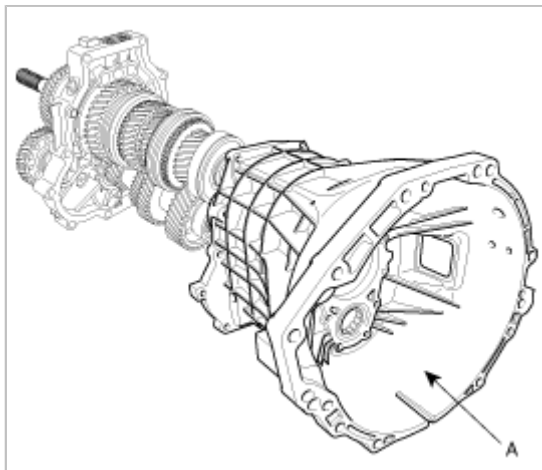

13. Using a pin punch, remove the 1st 2nd shift fork(A) mounting spring. Discard spring pins(B).

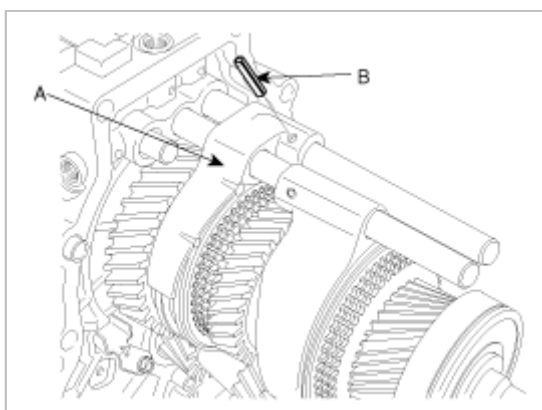

14. Using a pin punch, remove the 3rd 4th shift fork(B) mounting spring pin(A). Discard spring pins.

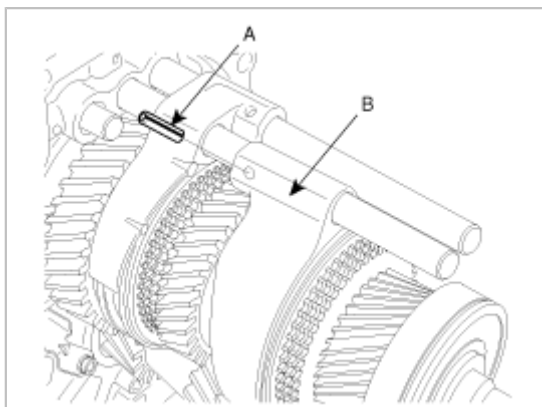

15. Using a pin punch, remove the 5th rev. shift fork(A) mounting spring pin(B). Discard spring pins.

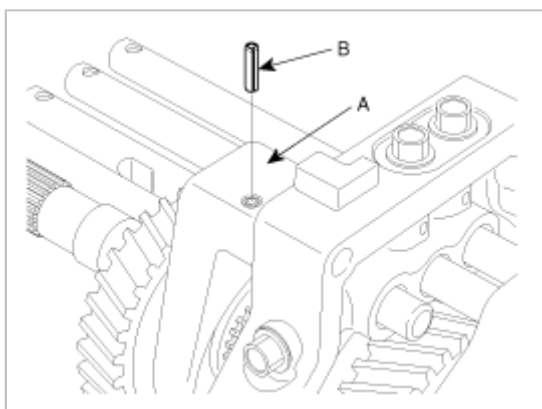

16. Remove the seal bolt(A), poppet spring(B) and steel ball from the intermediate plate.

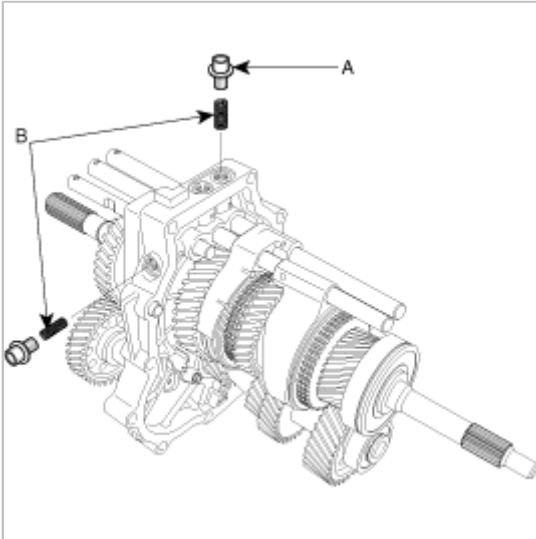

17. Remove the 1st 2nd shift(A) rail.

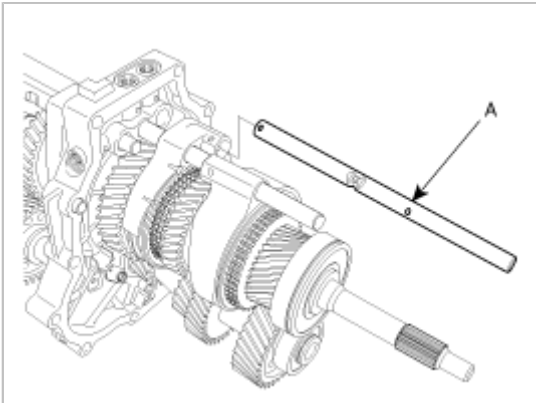

18. Remove the 3rd 4th shift rail(A).

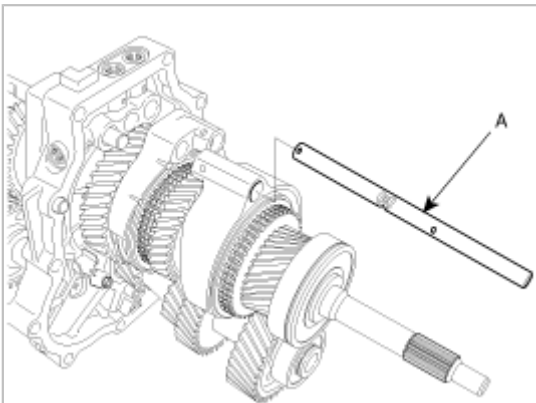

19. Remove the shift forks [(1/2(A) and 3/4(B)].

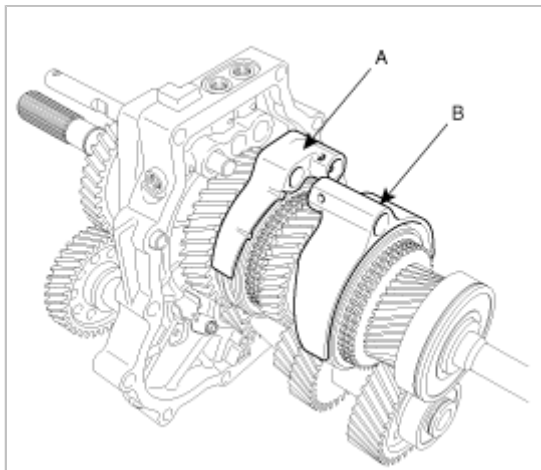

20. Remove the 5th shift fork(A) and rail(B) and shift lever assembly(C).

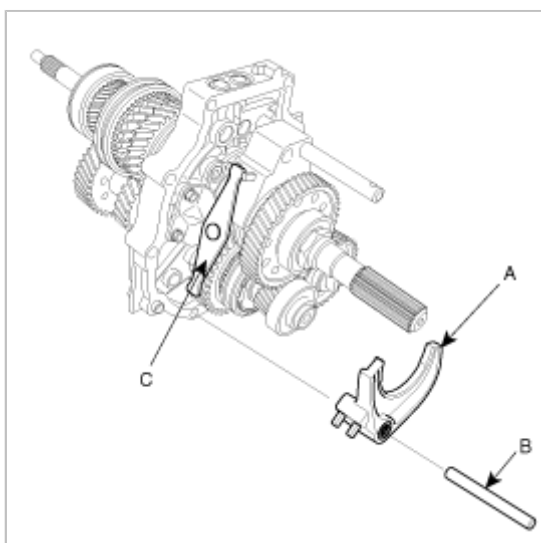

21. Remove the reverse shift rail retainer ring(A), shift rail(B) and fork(C).

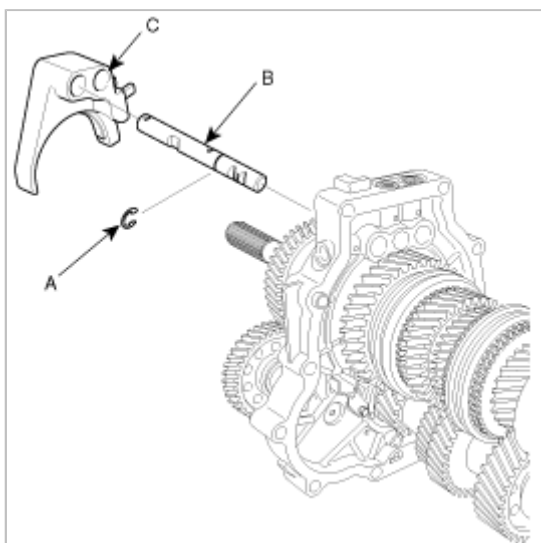

22. Remove the oil guide(A).

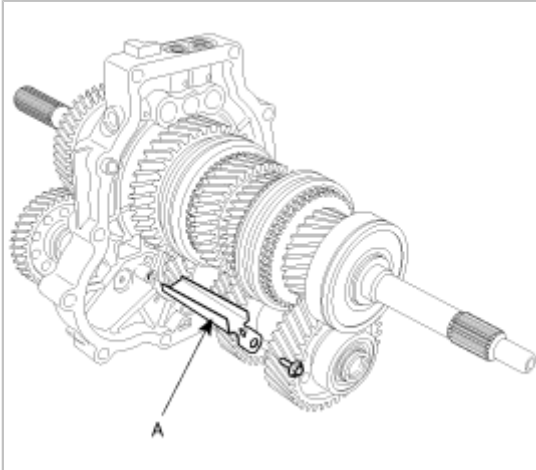

23. Using the special service tool (09432-H1100), remove the locking nuts from the main shaft(B) and the counter shaft(A).

Before the removal, be sure to remove the two calking marks from each locking nut.

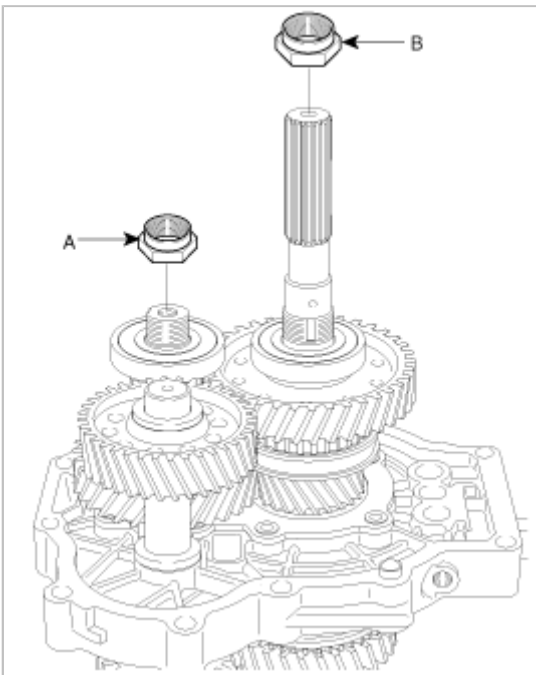

24. Using the special service tool (09432-11000), remove the counter shaft ball bearing(A).

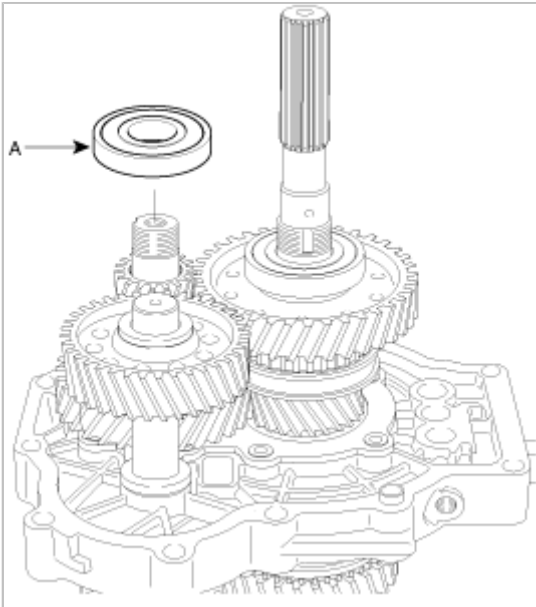

25. Remove the reverse idler gear assembly(A) with the shaft and spacer.

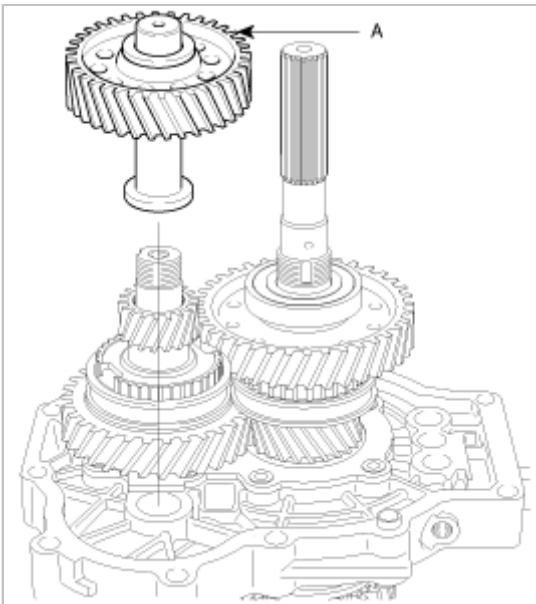

26. Remove the counter shaft reverse gear(A).



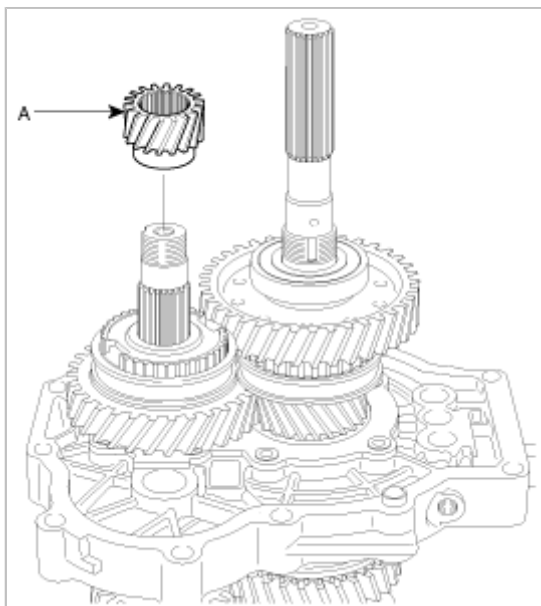

27. Using the special service tool (09432-11000), remove the main shaft ball bearing(A), thrust washer (B) and steel ball.

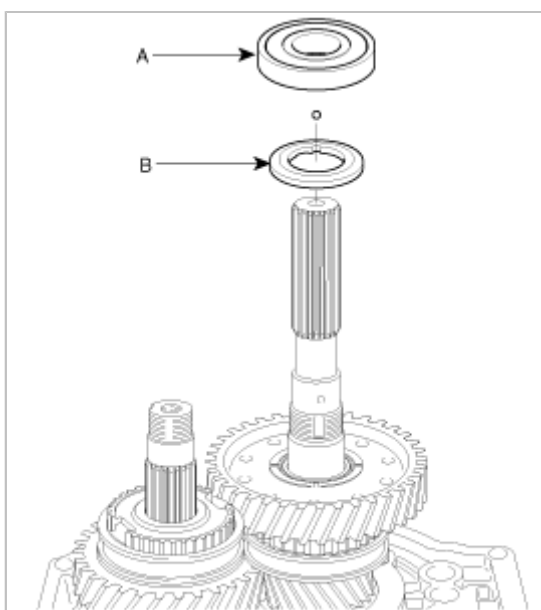

28. Remove the main shaft reverse gear(A).

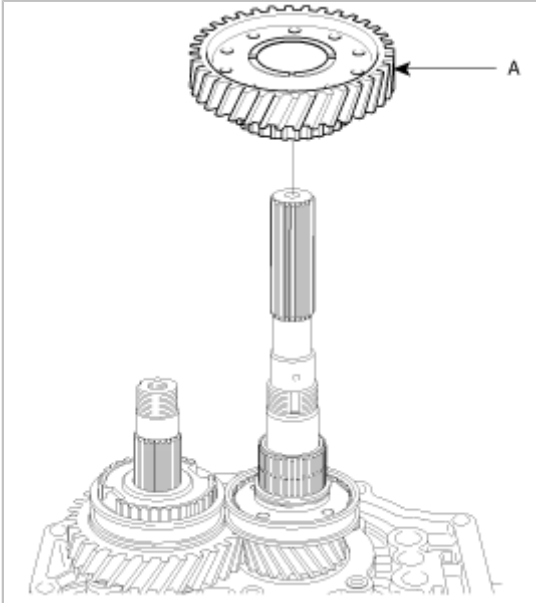

29. Remove the main shaft needle roller bearing(A) and reverse gear sleeve(B).

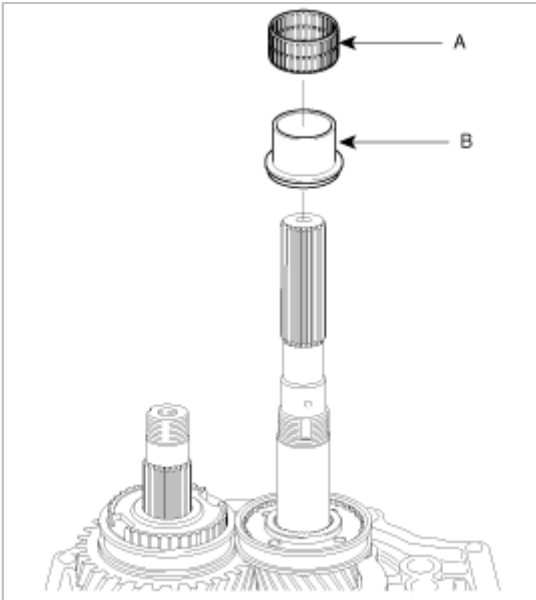

30. Remove the main shaft reverse synchronizer sleeve(A) and clutch gear(B).

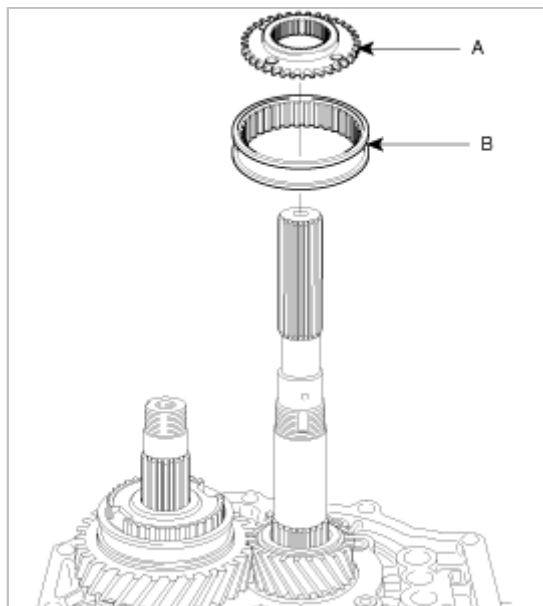

31. Remove the counter shaft 5th synchronizer sleeve(B) and hub(A).

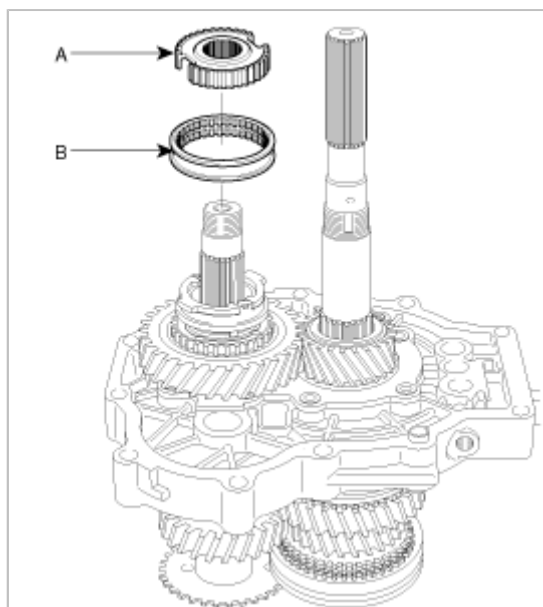

32. Remove the synchronizer lever(A) and double cone assembly(B).

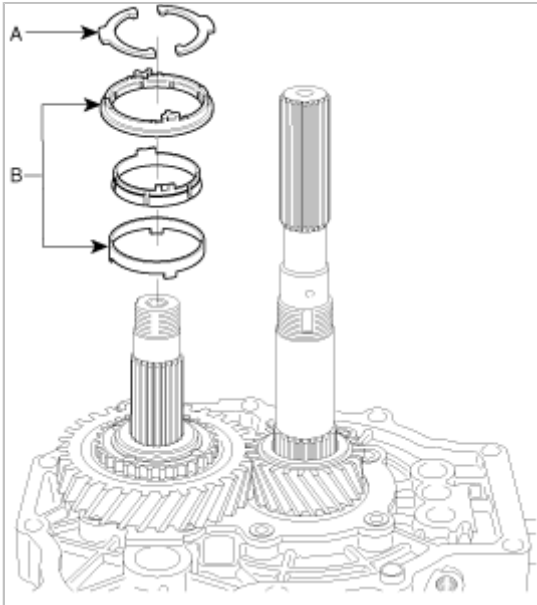

33. Remove the counter shaft spacer(A), over-top gear(B) and needle bearing(C).

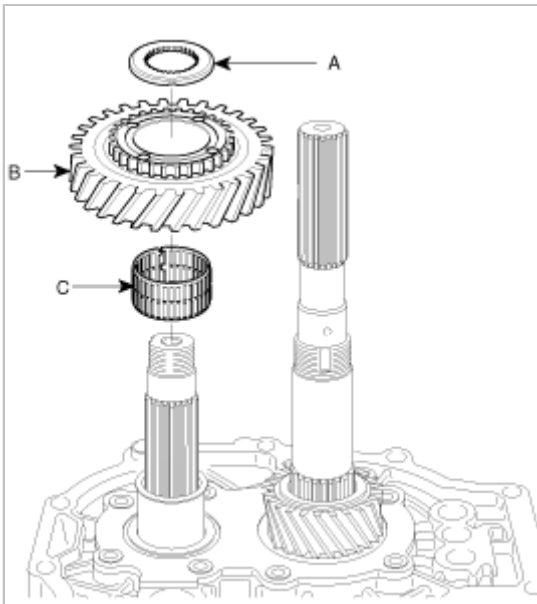

34. Remove the main shaft over-top gear(A).

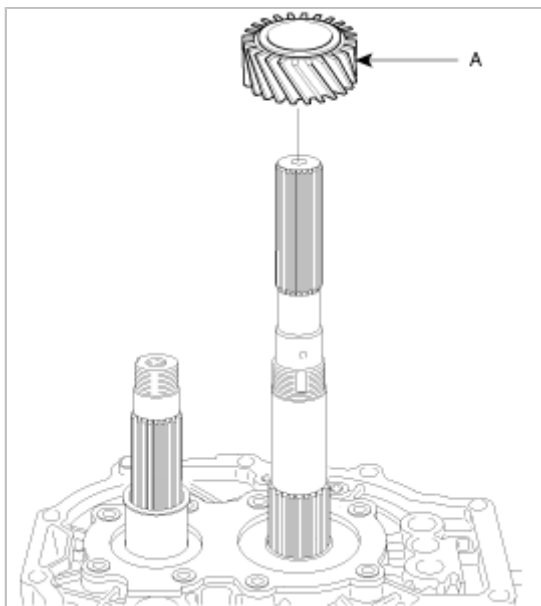

35. Using the hexagonal wrench (T40), remove the rear bearing retainer(A).

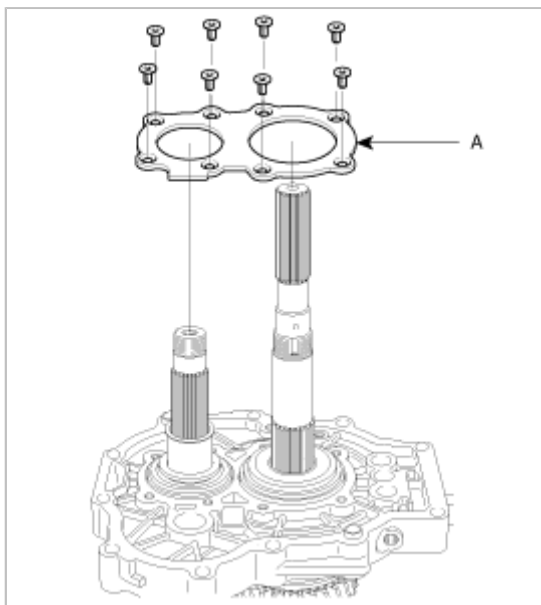

36. Remove the snap rings(A) from the main/counter shafts and the intermediate plate(B).

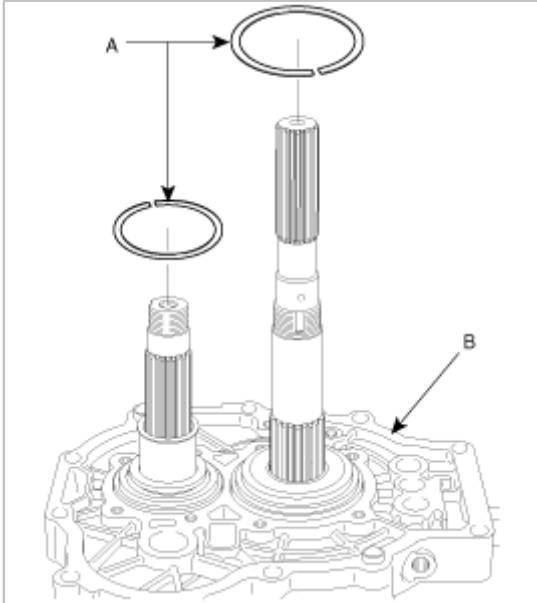

37. Separate the counter shaft from the main shaft and main drive pinion assembly.

38. Separate main drive pinion assembly(A) from the main shaft(B).

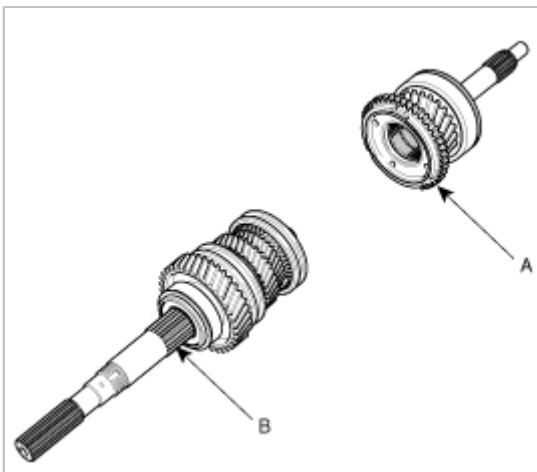

## REASSEMBLY

1. Connect the main shaft and the main drive pinion assembly together.
2. Install the main shaft and the counter shaft in the intermediate plate(B) with the snap rings(A).

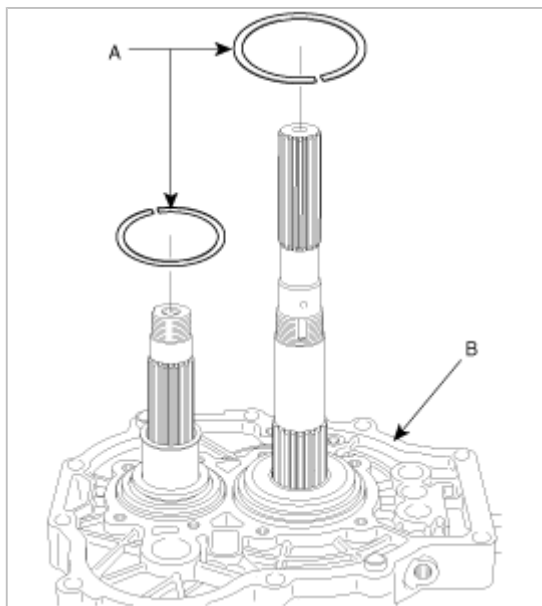

3. Using the hexagonal wrench (T40), install the rear bearing retainer(A).

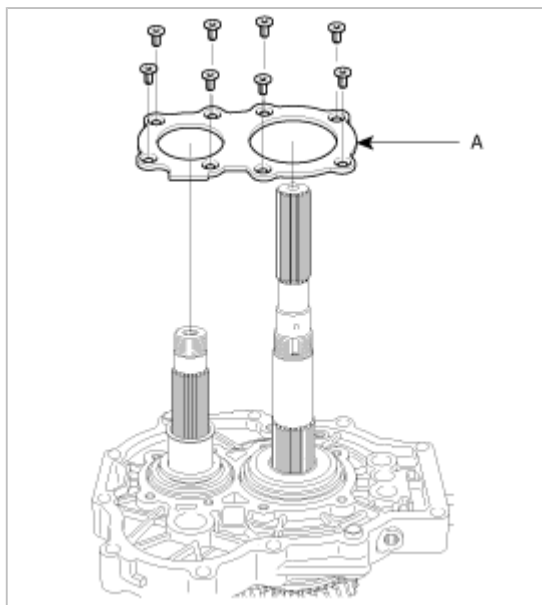

4. Insert the main shaft over-top gear, the counter shaft needle bearing(C), over-top gear(B) and spacer (A).

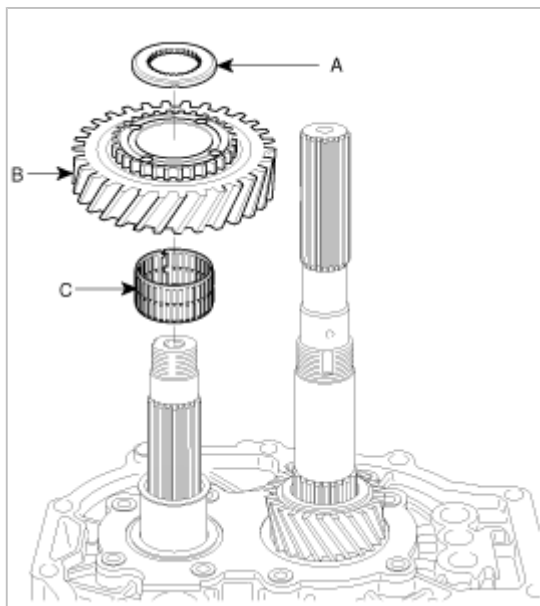

5. Install the synchronizer lever(A) and double cone assembly(B).

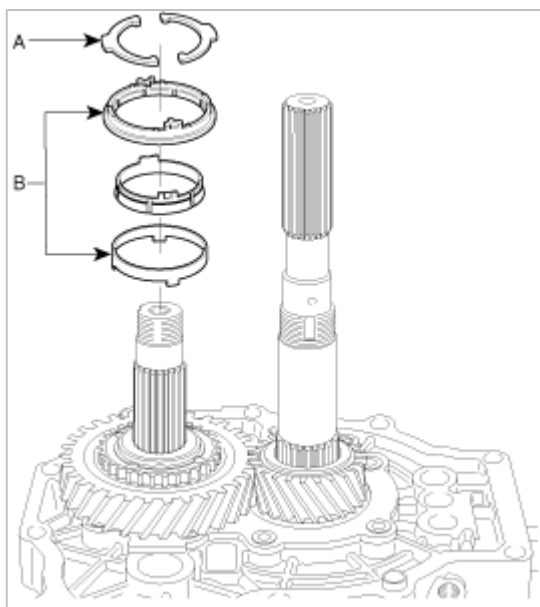

6. Install the main shaft reverse synchronizer sleeve(C) and clutch gear(D) and then, the counter shaft 5th synchronizer sleeve(B) and hub(A).



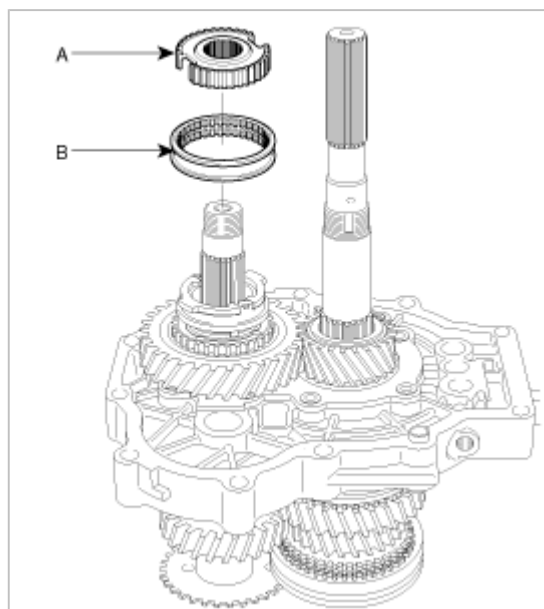
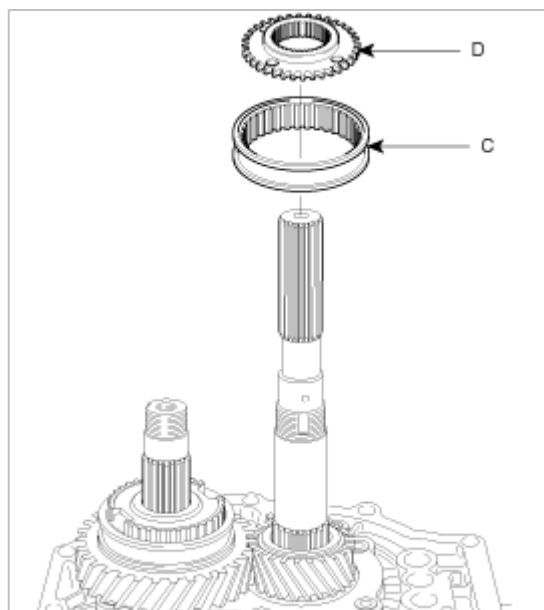

7. Install the reverse gear sleeve(B) and the main shaft needle roller bearing(A).

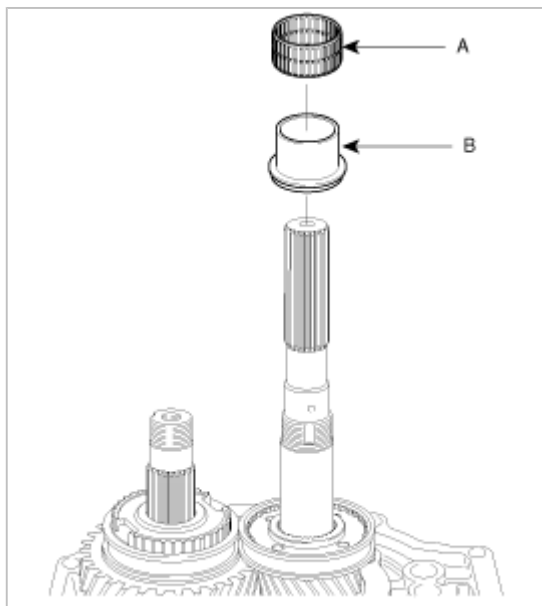

8. Using the special service tool (09432-33800), install the ball bearing(A) after inserting the main shaft reverse gear, steel ball and thrust washer.

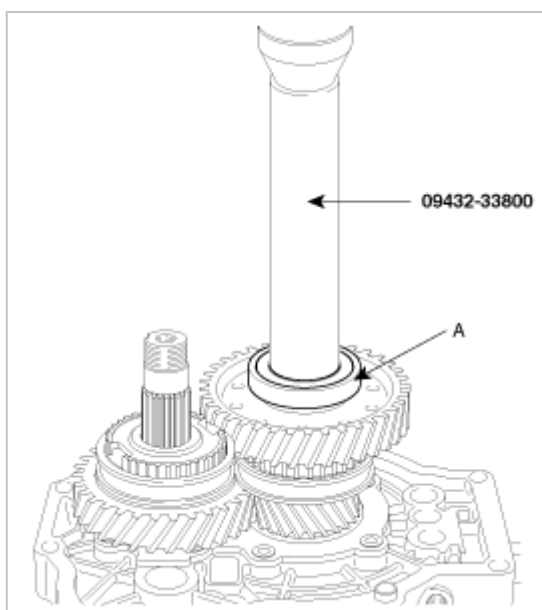

9. Install the counter shaft reverse gear(A).

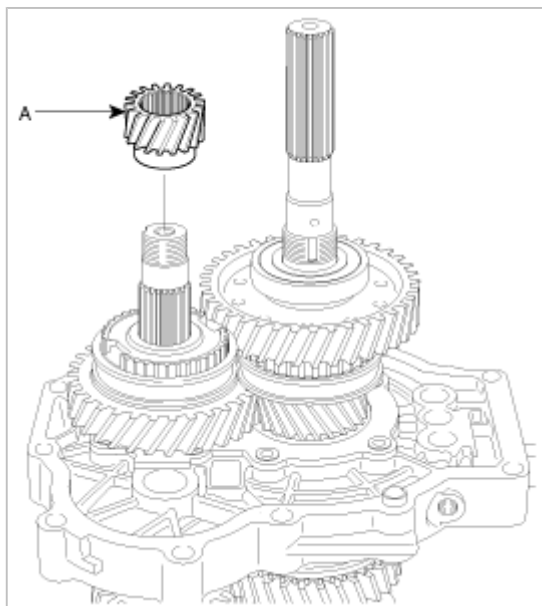

10. Install the reverse idler gear assembly(A) with the shaft and spacer.

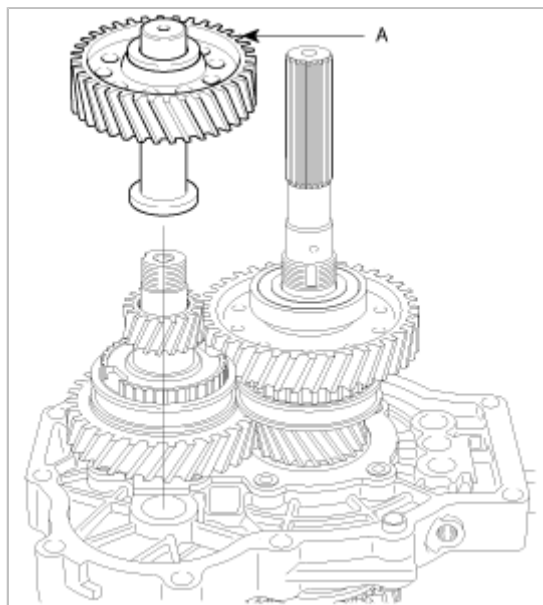

11. Using the special service tool (09432-33800) and a press machine, install the counter shaft ball bearing(A).

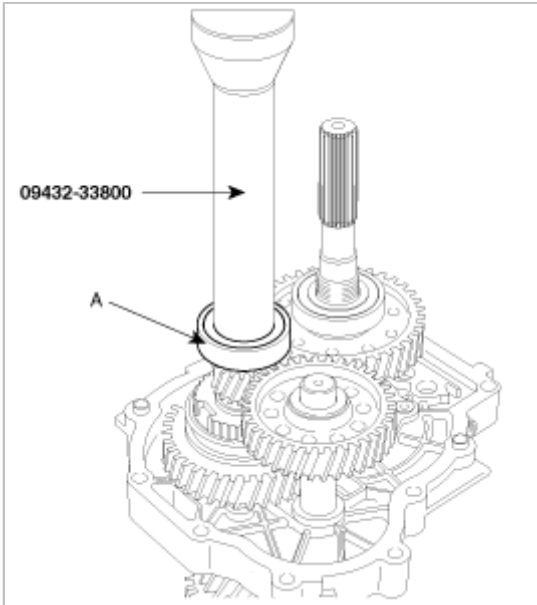

12. Using the special service tool (09432-H1100), tighten the locking nuts to the main shaft(B) and the counter shaft(A).

**TORQUE :**

245.2~264.8 Nm (2500~2700 kgf.cm, 180.8~195.3 lb-ft)

After fastening the locking nuts, be sure to calk two parts of each nut.

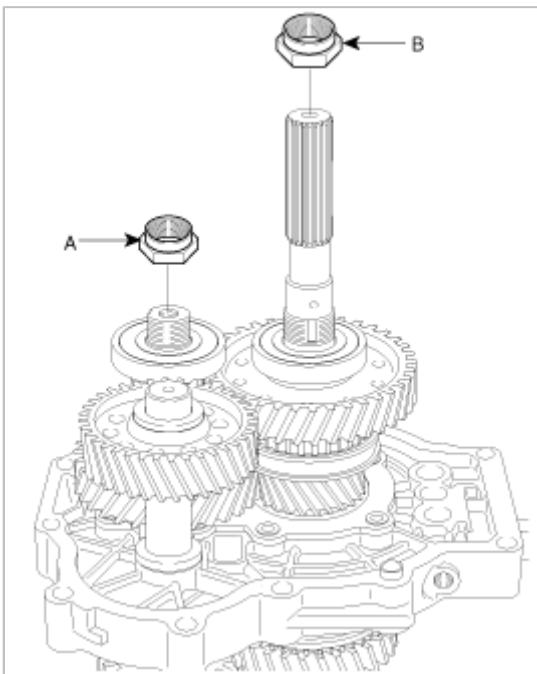

13. Install the oil guide(A).

**TORQUE :**

7.8~9.8 Nm (80~100 kgf.cm, 5.8~7.2 lb-ft)

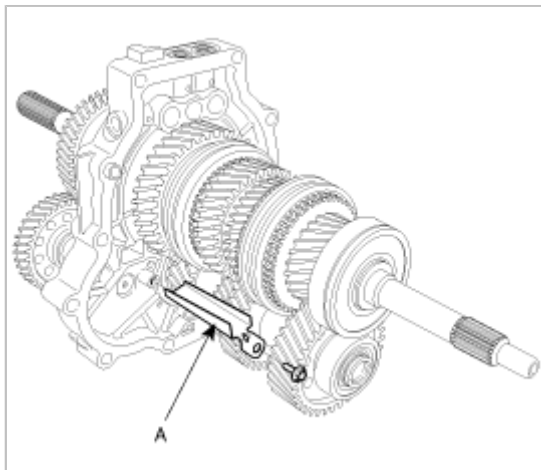

14. Insert the two interlock plungers in the intermediate plate.

15. Install the 5th/rev. shift rail retainer ring(A), shift rail(B) and fork(C). And insert the spring pin.

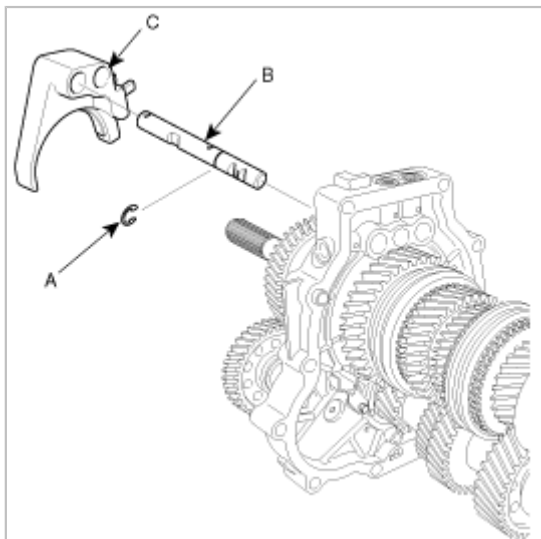

16. Install the shift lever assembly(C) with the torque shown as below and the 5th shift fork(A)/rail(B).

**TORQUE :**

14.7~21.6 Nm (150~220 kgf.cm, 10.8~15.9 lb-ft)

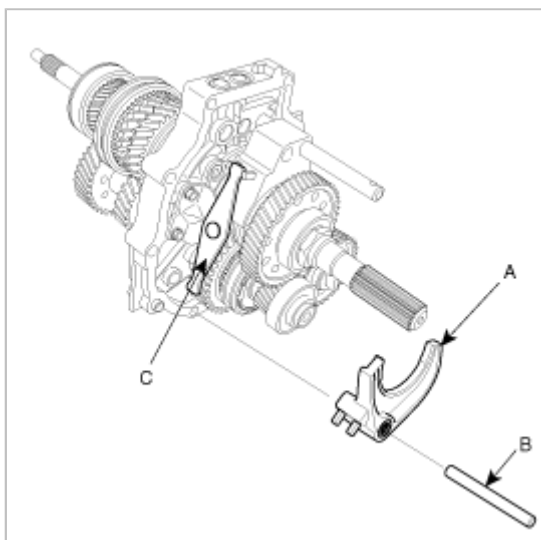

17. Install the shift forks [1/2(A) and 3/4(B)].

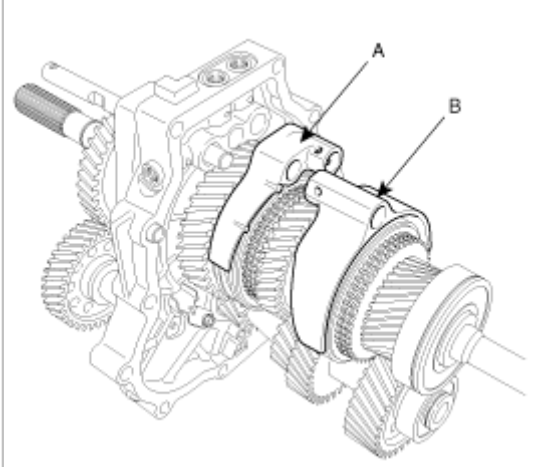

18. Install the shift rails (1/2 and 3/4).

19. After installing the steel bolt and poppet springs(B) in the intermediate plate, tighten the seal bolts (A).

TORQUE :

29.4~41.2 Nm (300~420 kgf.cm, 21.7~30.4 lb-ft)

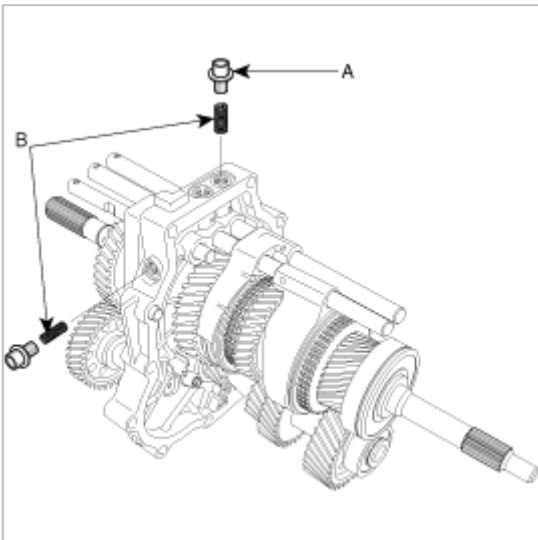

20. Insert the spring pins.

21. Install the transmission case assembly(A).

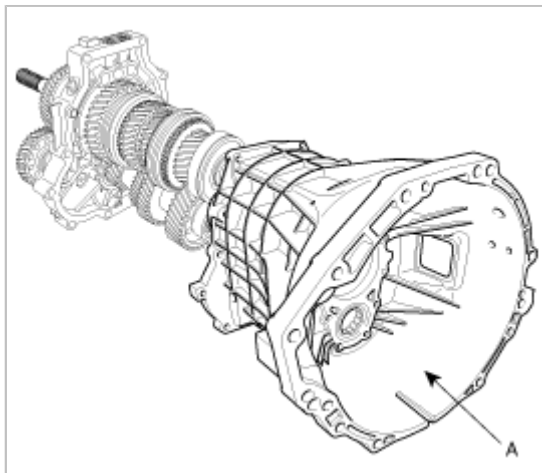

22. Install the snap ring(A).

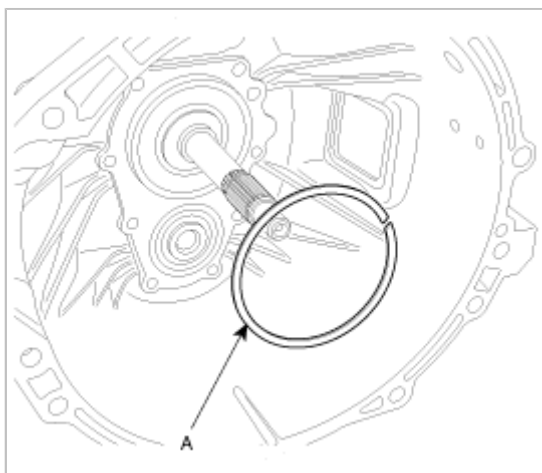

23. Using the height gauge, measure the dimension (C) between the front bearing retainer contact surface in the case and the main drive pinion ball bearing.

Measure the depth (B) between the front bearing retainer contact surface and the spacer contact surface in the retainer.

Select an appropriate spacer(A) thickness to be used for the main shaft by using the formula below.

**Spacer thickness : B - C - (snap ring end play value)**

---

Spacer end play specified value : 0~0.1mm

---

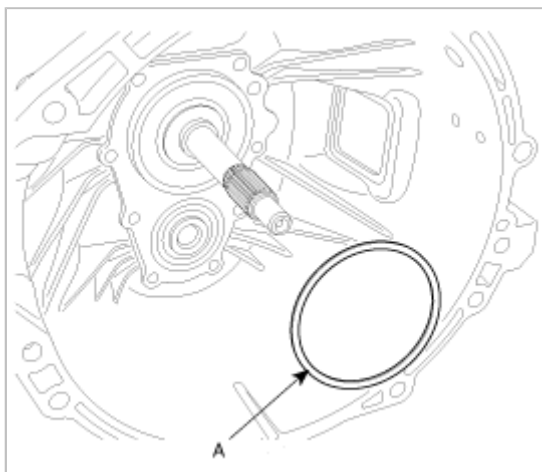

**SPACER thickness table**

Thickness (mm)	Part number
0.81	43217-49681
0.89	43217-49689
0.97	43217-49697
1.05	43217-49605
1.13	43217-49613

Install the front bearing retainer spacer(A).

24. Install the front bearing retainer assembly(A).

**TORQUE :**

14.7~21.6 Nm (150~220 kgf.cm, 10.8~15.9 lb-ft)

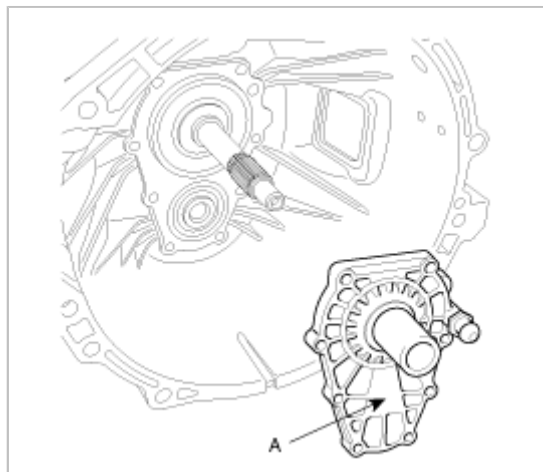

25. Install the transfer adapter(A).

**TORQUE :**

42.2~53.9 Nm (430~550 kgf.cm, 31.1~39.8 lb-ft)

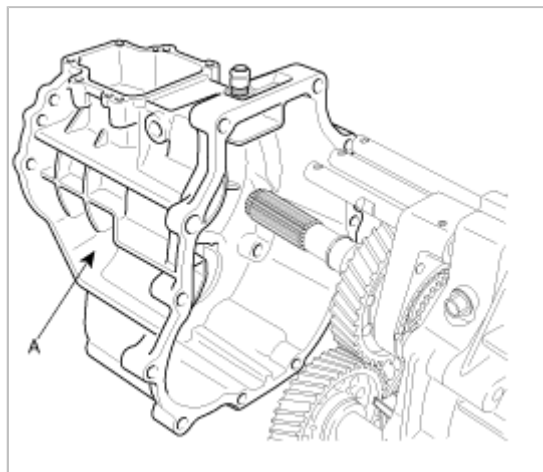

26. Install the shift control jaws and insert the spring pins.



27. Install the oil filler plug(A) and the back up lamp switch(B).

TORQUE :

Oil filler plug : 58.8~78.5 Nm (600~800 kgf.cm, 43.4~57.9 lb-ft)

Back up lamp switch : 29.4~34.3 Nm (300~350 kgf.cm, 21.7~25.3 lb-ft)

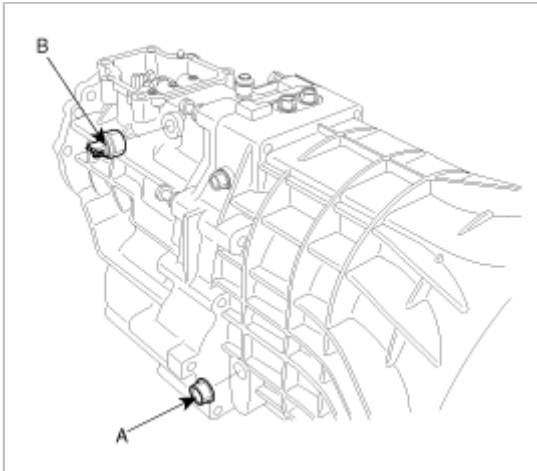

28. Install the transmission control housing assembly(A).

TORQUE :

14.7~21.6 Nm (150~220 kgf.cm, 10.8~15.9 lb-ft)

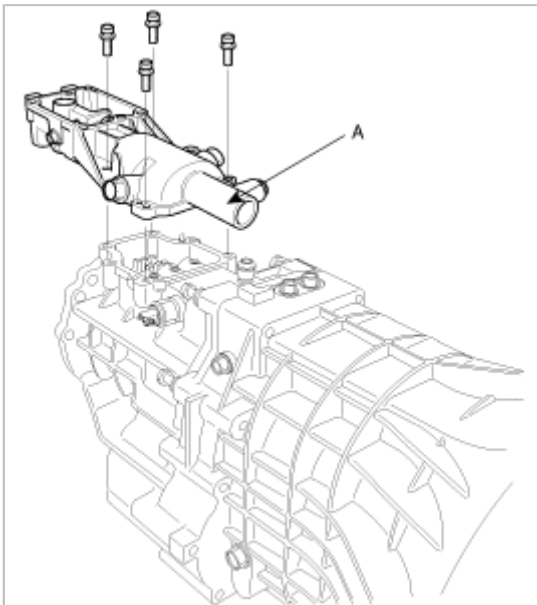

29. Install the control lever complete(A).

TORQUE :

14.7~21.6 Nm (150~220 kgf.cm, 10.8~15.9 lb-ft)

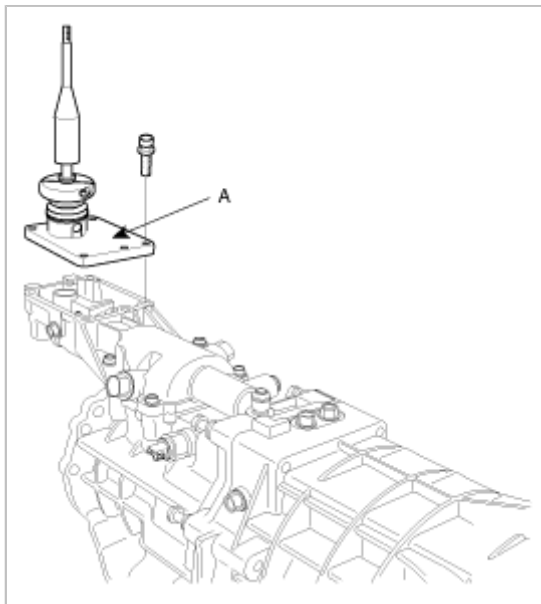

30. Install the clutch release bearing, fork(A) and fork boot.

